

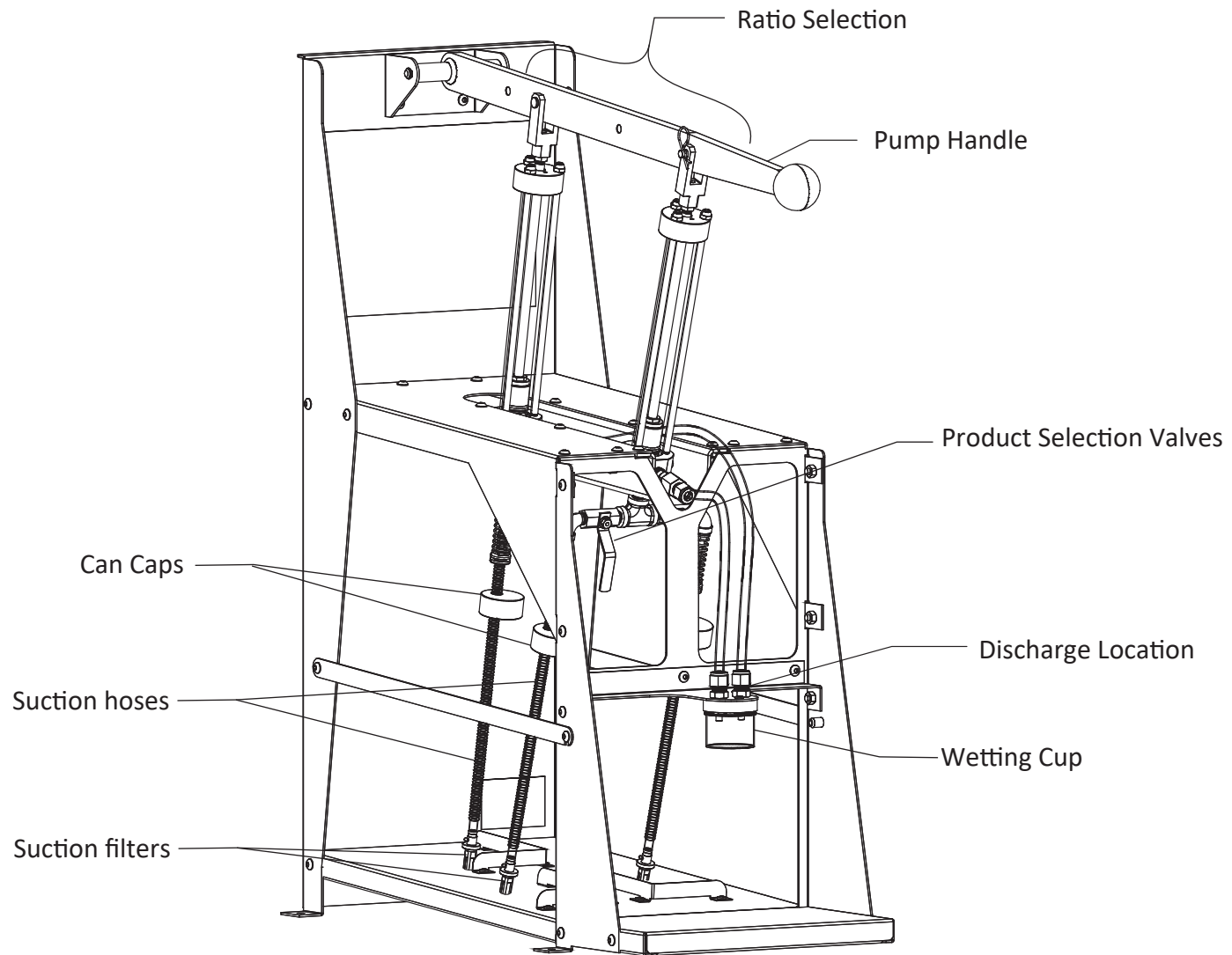

Components





Manual Proportioning Unit (MPU) User and Installation Guide

Set Up and Functions

Priming the MPU

- Place all three suction hoses in a container of Reducer or Acetone submerging the hose ends.
- Turn both of the product selector shut off valves for the front cylinder to the OPEN position (horizontal).
- Remove the wetting cup from the dispensing location and place an empty container beneath the machine.
- With the pump handle in the lowest position, apply very small quick pump strokes upward to prime the pumps.
- Slowly lift the pump handle to its full upward position, this will fill both glass cylinders with Reducer or Acetone.
- Pull the pump handle down to dispense the Reducer or Acetone out of the two tubes at the front of the machine.
- You are now ready to install the cans of product.

Based on the product that is intended for use, select the proper orientation of the cylinders to achieve the desired ratio.

Make sure that both pistons bottom out after adjusting the ratio by adjusting the height of the clevis.

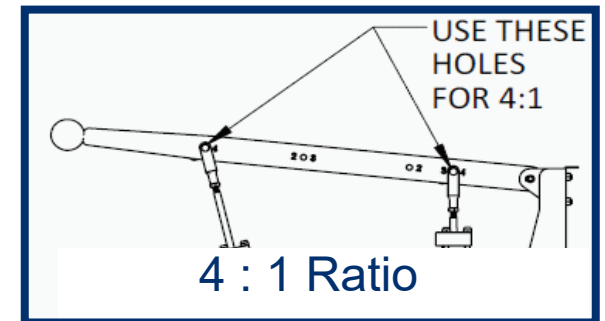
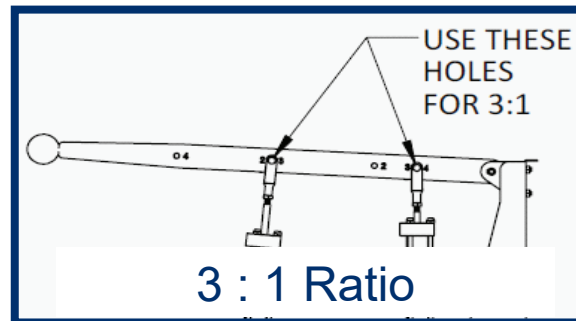
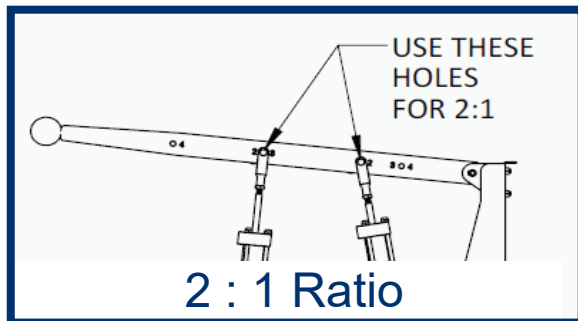



Manual Proportioning Unit (MPU) User and Installation Guide

Operating the proportioning unit:

You have a choice of three speeds of clear coat:

1. With only the left product selector open... This is the fast clear.
2. With only the right product selector open... This is the slow clear.
3. With both product selectors open... This is the medium clear.

- Before changing to a new selection of clear, make sure the pump handle is in the lowest position.
- Always finish the dispensing with the pump handle in the lowest position.
- If you require less than 5 fl oz., do not lift the handle fully.
- Do not try to operate with both product selector valves in the off positions (vertical).

Operating the proportioning unit:

Remove the Reducer or Acetone. Place the desired product containers into position under the cylinders, insert the suction hoses and place the can caps over the containers openings.

By turning the left product selector valve open (horizontal) and the right selector valve in the closed position (vertical) you can draw only from the can in the front left position. By turning the left product selector valve closed (vertical) and the right selector valve in the open position (horizontal) you can draw only from the can in the front right position.

Make sure to pump enough product through the unit to flush out the Reducer or Acetone used from the initial priming prior to first use.



After EVERY dispensing and at the end of EVERY work day:

- The two product selection valves must be in the closed position (vertical).
- Make sure the pump arm is in the lowest position.
- Add $\frac{1}{4}$ to $\frac{1}{2}$ inch of Reducer or Acetone to the wetting cup and reattach the cup.

Note:

DO NOT fill the wetting cup enough to submerge the tube openings.

Solvent MUST be below the tips to allow vapor inside the tubes.

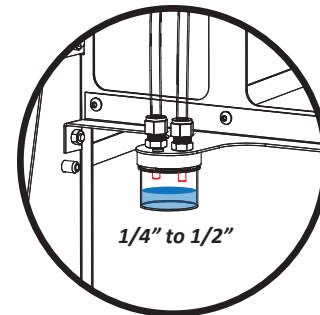
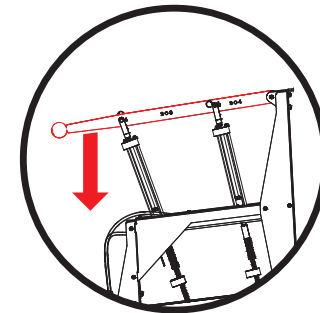
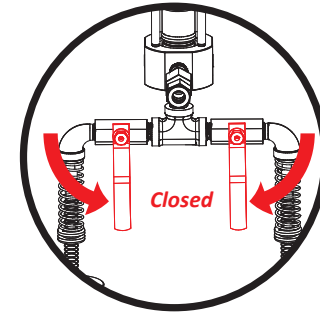

It is critical that the steps on this page are performed after each use and at the end of the day.

Failure to follow the steps will result in the materials drying and cause the pumps to harden requiring extensive cleaning and repair.



Manual Proportioning Unit (MPU) User and Installation Guide

Preventative Maintenance:

- Check the cylinders to ensure that no material is above the piston.
- If material has gotten above the piston, clean the cylinder immediately to prevent damage to components.
- Be sure to use the wetting cup at the end of each day.
- If material is not being drawn into the cylinders:

Remove check valve and soak in Reducer or Acetone.

Clean valve and attempt to actuate by pressing here:

Once confirmed that the valve is operating correctly,

reassemble valve to unit (using Loctite 567 thread sealant) in the original orientation.

- Make sure suction screens are clear to allow for unrestricted flow of material. Replace as needed.





Manual Proportioning Unit (MPU) User and Installation Guide

Warranty Policy

Dedoes Industries warrants the following parts against defects of workmanship and materials for the following periods:

36 Months: Frame

30 Days: Glass cylinders, pistons, check valves, and stainless steel fittings

This warranty covers these parts when defective or damaged due to equipment operational errors. This warranty does not cover any item that has been damaged due to mutilation, alteration, misuse, or abuse. Corrosion due to neglect or chemicals is not covered by this warranty. Dedoes Industries will not be responsible for loss of time, inconvenience, or other consequential damages. Under no circumstances should the unit or any part there-of be returned to the factory for inspection, replacement, and/or repair without the express written consent of Dedoes Industries.

This is the only warranty on the MPU02 and no other expressed warranty by anyone other than Dedoes, in writing, will be binding on the manufacturer. This warranty is non transferable.

IMPORTANT: USE ONLY DEDOES REPLACEMENT PARTS OR WARRANTY IS VOID.



Manual Proportioning Unit (MPU) User and Installation Guide

Part's List And Break Down

Discharge Assembly Components (A kit is not available)

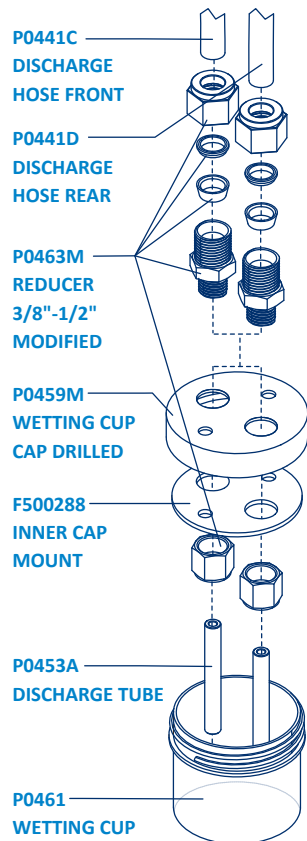

SA0091 Suction Hose Kit

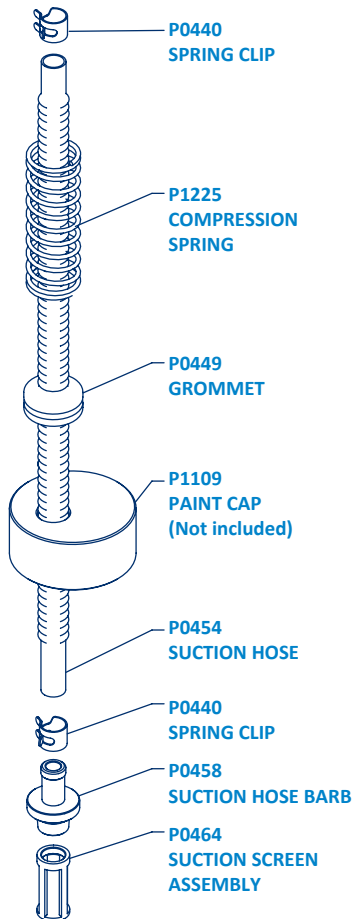

Front Suction Assembly Components (A kit is not available)

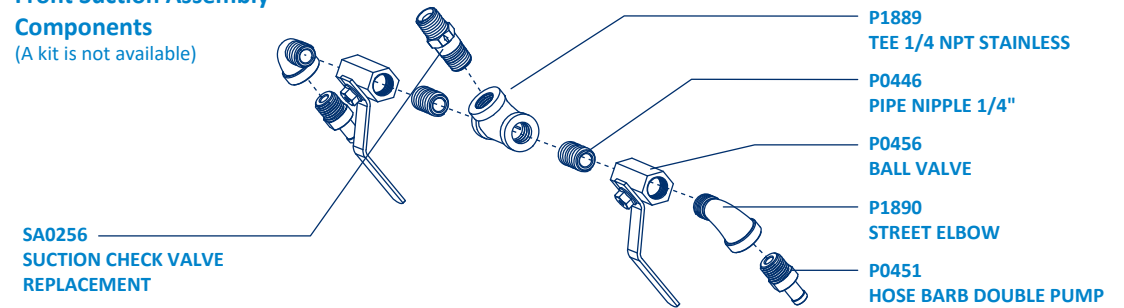

Back Suction Assembly Components (A kit is not available)

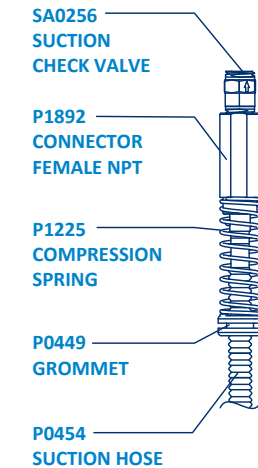

SA0215 Rear Discharge Hose Kit

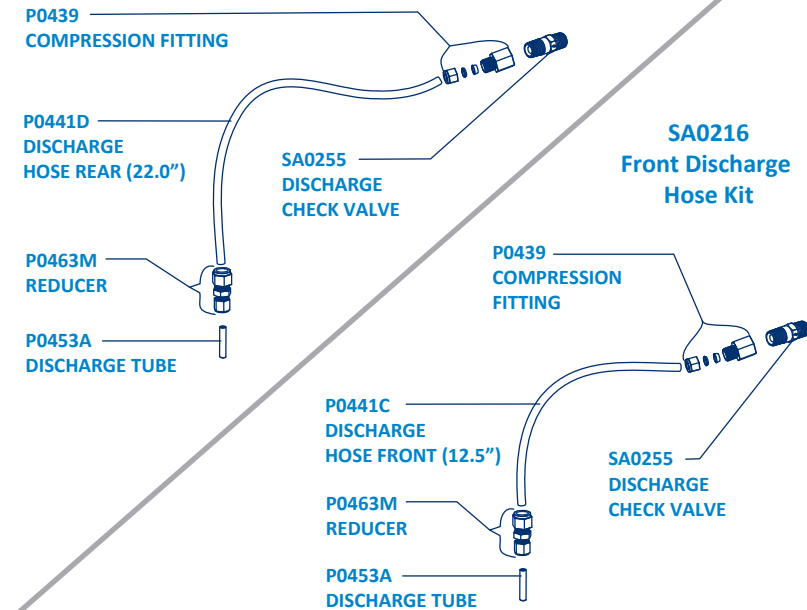



Manual Proportioning Unit (MPU) User and Installation Guide

